

Submit In Quadruplicate To:

MONTANA BOARD OF OIL AND GAS CONSERVATION
2535 ST. JOHNS AVENUE
BILLINGS, MONTANA 59102

RECEIVED**MAR 21 2025****SUNDRY NOTICES AND REPORT OF WELLS****MONTANA BOARD OF OIL &
GAS CONSERVATION • BILLINGS**

Operator White Rock Oil & Gas, LLC.		Lease Name: Putnam Farms
Address 5810 Tennyson Pkwy, Suite 500		Type (Private/State/Federal/Tribal/Allotted): Private
City Plano	State TX	Zip Code 75024
Telephone (214) 981-1400		Well Number: 43X-18
Fax		Unit Agreement Name:
Location of well (1/4-1/4 section and footage measurements): NE SE, 1700 FSL & 600 FEL		Field Name or Wildcat: Elm Coulee
API Number: 25 083 22289 State County Well		Township, Range, and Section: 23N, 57E, 18
Well Type (oil, gas, injection, other): Oil		County: Richland

Indicate below with an X the nature of this notice, report, or other data:

Notice of Intention to Change Plans	<input type="checkbox"/>	Subsequent Report of Mechanical Integrity Test	<input type="checkbox"/>
Notice of Intention to Run Mechanical Integrity Test	<input type="checkbox"/>	Subsequent Report of Stimulation or Treatment	<input type="checkbox"/>
Notice of Intention to Stimulate or to Chemically Treat	<input checked="" type="checkbox"/>	Subsequent Report of Perforation or Cementing	<input type="checkbox"/>
Notice of Intention to Perforate or to Cement	<input type="checkbox"/>	Subsequent Report of Well Abandonment	<input type="checkbox"/>
Notice of Intention to Abandon Well	<input type="checkbox"/>	Subsequent Report of Pulled or Altered Casing	<input type="checkbox"/>
Notice of Intention to Pull or Alter Casing	<input checked="" type="checkbox"/>	Subsequent Report of Drilling Waste Disposal	<input type="checkbox"/>
Notice of Intention to Change Well Status	<input type="checkbox"/>	Subsequent Report of Production Waste Disposal	<input type="checkbox"/>
Supplemental Well History	<input type="checkbox"/>	Subsequent Report of Change in Well Status	<input type="checkbox"/>
Other (specify) _____	<input type="checkbox"/>	Subsequent Report of Gas Analysis (ARM 36.22.1222)	<input type="checkbox"/>

Describe Proposed or Completed Operations:

Describe planned or completed work in detail. Attach maps, well-bore configuration diagrams, analyses, or other information as necessary. Indicate the intended starting date for proposed operations or the completion date for completed operations.

Dual Lateral Cleanout/Liner Installation/Refrac Procedure. Objective – isolate and frac both laterals independently. Procedure, schematics, and chemical disclosure are attached. The intended rig work starting date is 4/14/2025.

**SEE ATTACHED
CONDITIONS OF APPROVAL**

BOARD USE ONLY	
Approved MAR 20 2025	Date
	Name
Admin/Reg. Engineer	Title

The undersigned hereby certifies that the information contained on this application is true and correct:

3/18/2025



Date

Signed (Agent)

Sam Lyness (Regulatory Analyst)

Print Name and Title

Telephone:

(214) 981-1400

SUPPLEMENTAL INFORMATION

NOTE: Additional information or attachments may be required by Rule or by special request.

Plot the location of the well or site that is the subject of this notice or report.

RECEIVED

MAR 21 2025

MONTANA BOARD OF OIL &
GAS CONSERVATION • BILLINGS

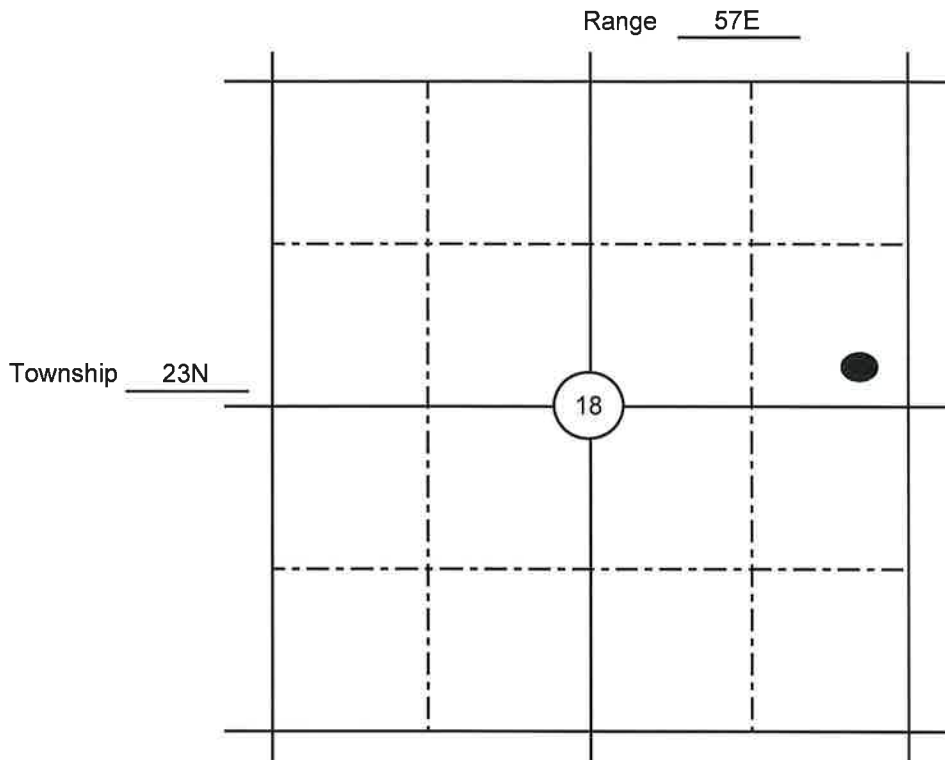

BOARD USE ONLY

CONDITIONS OF APPROVAL

The operator must comply with the following condition(s) of approval:

Failure to comply with the conditions of approval may void this permit.

08322289

Fracture Start Date/Time:	
Fracture End Date/Time:	
State:	Montana
County:	Richland County
API Number:	
Operator Number:	
Well Name:	25 Stages
Federal Well:	No
Trifid Well:	No
Longitude:	1.0001
Latitude:	1.0001
Long/Lat Projection:	
True Vertical Depth (TVD):	10,000'
Total Clean Fluid Volume* (gal):	4,034,730
Water Source:	Fresh
Water Source TDS:	
Water Source Percent:	100



Additive	Specific Gravity	Additive Quantity
Water	1.00	4,034,730
Sand (100 Mesh Proppant)	2.65	830,000
Sand (40/70 White Proppant)	2.65	3,320,600
Hydrochloric Acid (7.5%)	1.04	13,750
Acid Pack Pro III	1.10	35
ProSlick 978	1.10	5,245
ProSurf 171	1.02	4,815
BioSonicGQ123X	1.04	480
ProCheck 170	1.03	204
-	-	-
-	-	-
-	-	-
-	-	-
-	-	-
-	-	-
-	-	-
-	-	-
-	-	-
-	-	-
-	-	-
-	-	-

Ingredients Section:

Trade Name	Supplier	Purpose	Ingredients	Chemical Abstract Service Number (CAS #)	Maximum Ingredient Concentration in Additive (% by mass)**	Mass per Component (LBS)
Water	Opendor	Carrier Base Fluid	Water	7732-18-5	100.00%	33,609,822
Sand (100 Mesh Proppant)	ProPac	Proppant	Crystalline Silica (quartz)	14808-60-7	100.00%	830,000
Sand (40/70 White Proppant)	ProPac	Proppant	Crystalline Silica (quartz)	14808-60-7	100.00%	3,320,600
Hydrochloric Acid (7.5%)	Reogen	Acidizing	Hydrochloric Acid	7647-39-0	7.50%	8,928
ProSurf 171	ProPac	Surfactant	Water	7732-18-5	92.50%	110,118
			Methyl alcohol	67-56-1	30.00%	13,098
			Surfactant	68603-12-0	30.00%	3,424
			Ethyl alcohol	64-175-1	30.00%	13,098
Acid Pack Pro III	QSR	Acid Inhibitor	Indolesulfonic, ethoxylated	9010-30-5	1.75%	9
			Alcohols C12-14 secondary, ethoxylated	84123-50-3	8.00%	0
			Methyl 9-octadecanoate	25601-41-6	1.00%	5
			Methyl 9-undecanoate	92102-17-0	1.00%	5
			Sodium xylene sulfonate	1300-72-7	0.25%	1
			Cine Acid	77-92-9	10.00%	50
			Pyridinium, 1-(p-tolylmethyl)-1,1'-di-Me-deriv, chloride	68609-18-2	25.00%	126
			Ethylene glycol	107-21-3	32.00%	212
			Water	7732-18-5	5.00%	25
			2-Propanol, 3-picolyl	104-55-2	4.00%	20
			Methanol	67-56-1	2.00%	10
ProSlick 978	ProPac	Friktion Reducer	Methyl alcohol	67-56-1	30.00%	19,259
			Surfactant	68603-12-0	10.00%	4,815
BioSonicGQ123X	BioSonic	Bioerol	Gluconolactone	111-30-8	15.00%	78
			Allyl dimethyl benzyl ammonium chloride (C13-16)	68124-85-1	5.00%	262
ProCheck 170	ProPac	Scale Inhibitor	Methyl alcohol	67-56-1	3.00%	174

RECEIVED

MAR 21 2025

MONTANA BOARD OF OIL &
GAS CONSERVATION • BILLINGS

08322289

MONTANA BOARD OF OIL AND GAS ATTACHMENT TO FORM 2 "CONDITIONS OF APPROVAL"

A. Field Inspector must be notified at least **24 hours** in advance of the start of fracture stimulation operation.

B. 36.22.1106 SAFETY AND WELL CONTROL REQUIREMENTS – HYDRAULIC FRACTURING

(1) New and existing wells which will be stimulated by hydraulic fracturing must demonstrate suitable and safe mechanical configuration for the stimulation treatment proposed.

(2) Prior to initiation of fracture stimulation, the operator must evaluate the well. If the operator proposes hydraulic fracturing through production casing or through intermediate casing, **the casing must be tested to the maximum anticipated treating pressure**. If the casing fails the pressure test it must be repaired or the operator must use a temporary casing string (fracturing string).

(a) **If the operator proposes hydraulic fracturing through a fracturing string, it must be strung into a liner or run on a packer set not less than 100 feet below the cement top of the production or intermediate casing and must be tested to not less than maximum anticipated treating pressure minus the annulus pressure applied between the fracturing string and the production or intermediate casing.**

(3) A casing pressure test will be considered successful if the pressure applied has been held for 30 minutes with no more than ten percent pressure loss.

(4) A **pressure relief valve(s)** must be installed on the treating lines between pumps and wellhead to limit the line pressure to the test pressure determined above; the well **must be equipped with a remotely controlled shut-in device** unless waived by the board administrator should the factual situation warrant.

(5) **The surface casing valve must remain open** while hydraulic fracturing operations are in progress; the annular space between the fracturing string and the intermediate or production casing must be monitored and may be pressurized to a pressure not to exceed the pressure rating of the lowest rated component that would be exposed to pressure should the fracturing string fail.

History: 82-11-111, MCA; IMP, 82-11-111, MCA; NEW, 2011 MAR p. 1686, Eff. 8/26/11.

C. 36.22.1010 WORK-OVER, RECOMPLETION, WELL STIMULATION – NOTICE AND APPROVAL

(1) Within 30 days following completion of the well work, a subsequent report of the actual work performed must be submitted on Form No. 2.